



Imaged Document Cover Sheet

The document following this cover sheet is an imaged document supplied by LANDATA®, Victorian Land Registry Services.

Document Type	Plan
Document Identification	TP771008S
Number of Pages (excluding this cover sheet)	2
Document Assembled	27/05/2021 12:06

Copyright and disclaimer notice:

© State of Victoria. This publication is copyright. No part may be reproduced by any process except in accordance with the provisions of the Copyright Act 1968 (Cth) and for the purposes of Section 32 of the Sale of Land Act 1962 or pursuant to a written agreement. The information is only valid at the time and in the form obtained from the LANDATA® System. None of the State of Victoria, LANDATA®, Victorian Land Registry Services Pty. Ltd. ABN 86 627 986 396 as trustee for the Victorian Land Registry Services Trust ABN 83 206 746 897 accept responsibility for any subsequent release, publication or reproduction of the information.

The document is invalid if this cover sheet is removed or altered.

TITLE PLAN	EDITION 1	TP 771008S
------------	-----------	------------

<p>Location of Land</p> <p>Parish: MARYBOROUGH Township: MARYBOROUGH Section: 34C Crown Allotment: 9 Crown Portion:</p> <p>Last Plan Reference: Derived From: VOL 2604 FOL 712 Depth Limitation: 50 FEET</p>	<p style="text-align: center;">Notations</p> <p>SUBJECT TO THE RESERVATIONS EXCEPTIONS CONDITIONS AND POWERS CONTAINED IN CROWN GRANT VOL. 2604 FOL. 712 AND NOTED ON SHEET 2 OF THIS PLAN</p> <p>ANY REFERENCE TO MAP IN THE TEXT MEANS THE DIAGRAM SHOWN ON THIS TITLE PLAN</p>
---------------------------------------------------------------------------------------------------------------------------------------------------------------------------------------------------------------------------------------------------------------------------------------------------	------------------------------------------------------------------------------------------------------------------------------------------------------------------------------------------------------------------------------------------------------------------------------------------

Description of Land / Easement Information	<p>THIS PLAN HAS BEEN PREPARED FOR THE LAND REGISTRY, LAND VICTORIA, FOR TITLE DIAGRAM PURPOSES AS PART OF THE LAND TITLES AUTOMATION PROJECT</p> <p>COMPILED: 30/01/2003 VERIFIED: L.S.</p>
--------------------------------------------	-----------------------------------------------------------------------------------------------------------------------------------------------------------------------------------------------------------

COLOUR CODE
Y=YELLOW

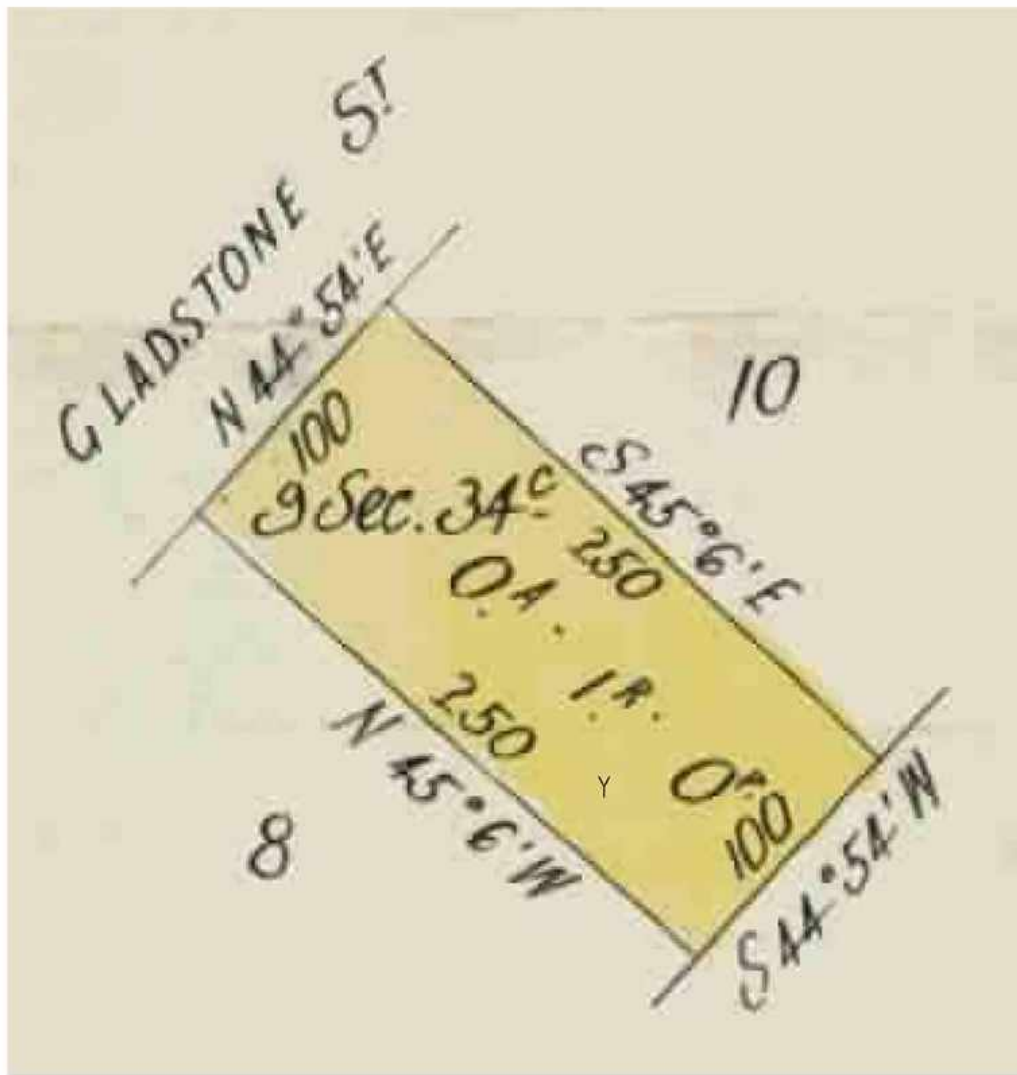

TITLE PLAN

TP 771008S

LAND DESCRIPTION INCLUDING RESERVATIONS EXCEPTIONS
CONDITIONS AND POWERS SHOWN ON THE CROWN GRANT

one rood more or less being allotment nine of Section thirty four in the Township of Maryborough Parish of Maryborough County of Galway **All THAT PIECE OF LAND** in the said Colony containing

delineated with the measurements and abutments thereof in the map drawn in the margin of these presents and therein coloured yellow PROVIDED however that the grantee shall be entitled to sink wells for water and to the use and enjoyment of any spring or springs of water upon or within the boundaries of the said land for any and for all purposes as though he held the land without limitation as to depth EXCEPTING however unto us our heirs and successors all gold and silver and auriferous and argentiferous earth or stone and all mines containing gold silver copper tin antimony coal and all other metals and minerals and mineral ores whatsoever and all mines seams lodes and deposits containing gold silver copper tin antimony coal and other metals and minerals and mineral ores in upon and under and within the boundaries of the land hereby granted AND ALSO reserving to us our heirs and successors free liberty and authority for us our heirs and successors and our and their agents and servants at any time or times hereafter to enter upon the said land and to search and mine therein for gold silver copper tin antimony coal and all other metals and minerals and mineral ores and to extract and remove therefrom any gold silver and any auriferous and argentiferous earth or stone copper tin antimony coal and other metals and minerals and mineral ores and to search for and work dispose of and carry away the gold silver copper tin antimony coal metals minerals and their ores and the mines metals and minerals in the land lying in upon and under the land hereby granted and for the purposes aforesaid to sink shafts make drives erect machinery and to carry on any works and do any other things which may be necessary or usual in mining and with all other incidents that are necessary to be used for the getting of the said gold silver copper tin antimony coal and other metals and minerals and mineral ores and the working of all mines seams lodes and deposits containing gold silver copper tin antimony coal and other metals and minerals and mineral ores in upon or under the land hereby granted

PROVIDED ALWAYS that the said land is and shall be subject to be resumed for mining purposes under section 68 of the Land Act 1890 AND PROVIDED also that the said land is and shall be subject to the right of any person being the holder of a miner's right or of a licence to search for metals or minerals or of a mining or mineral lease to enter therein and to mine for gold silver copper tin antimony coal and other metals and minerals and mineral ores and to erect and to occupy mining plant or machinery thereon in the same manner and under the same conditions and provisions as those to which the holder of a miner's right or of a mining or mineral lease had at the time of the passing of the Land Act 1890 the right to mine for gold and silver in and upon Crown lands PROVIDED THAT compensation shall be paid to the said **GRANTEE**

his heirs executors administrators assigns and transferees by such person for surface damage to be done to such lands by reason of mining thereon such compensation to be determined as provided by the 121st section of the said Act and the payment thereof to be a condition precedent to such right of entry.

LENGTHS ARE IN
LINKS

Metres = 0.3048 x Feet
Metres = 0.201168 x Links

Sheet 2 of 2 sheets